

Design with Nature and People

The works of O Studio Architects demonstrate a strong sensibility to design architecture with nature and people. O Studio Architects have delivered numerous award-winning projects including Church of Seed, Luofu Mountain Museum, WKCDA Art Pavilion, Xiqu Center, Fanling Classic Car Museum and Hong Kong Science Park Building which built harmonious connection between architecture, nature and people.

Church of Seed

Certificate of Excellence, 2012 Perspective Awards
Medal of the Year, 2011 HKIA Annual Award
Winner, 2011 World Architecture Community Award

Location Huizhou, China

Site Area 1200m²

Floor Area 280m²

Status Built 2011

Design Architect O Studio Architects

Designer in Charge Fai Au

Church of Seed blends bamboo textured concrete with surrounding bamboos and trees, encourages free flow of air and light, and brings people closer to nature.

Church of Seed is located at Luofu Mountain Scenery District - one of the seven famous Taoist Mountains in China. This church provides not only worship and meditation space for Christians, but also recreational and gathering places for the surrounding village people. Instead of promoting Christian religion actively and aggressively, the message of religion is communicated subtly through the play of light and shadow in this architecture.

Situated within the beautiful landscape of Luofu Mountain, Church of Seed has an area of 280m² and can accommodate 60 people. The design concept is triggered by the form of a seed - a famous metaphorical element in the Gospel stories. A curve line follows the outline of a seed and marks the enclosing wall element. The curve is then split into three parts, and three entries are formed at where the curve wall splits: the south east facing wall has a cross shape opening which introduces morning sun into the interior; the west facing wall is solid and blocking the afternoon sun; the north facing wall is thickened to accommodate toilet facility. The stepping roof terrace allows diffuse northern daylight into the interior and provides a dramatic headroom increment (3 - 12 meters) from the main entrance towards the worshiping space. Visitors can walk up to the stepping roof terrace, arrive at the observation deck and enjoy the distant view of mountain and water.

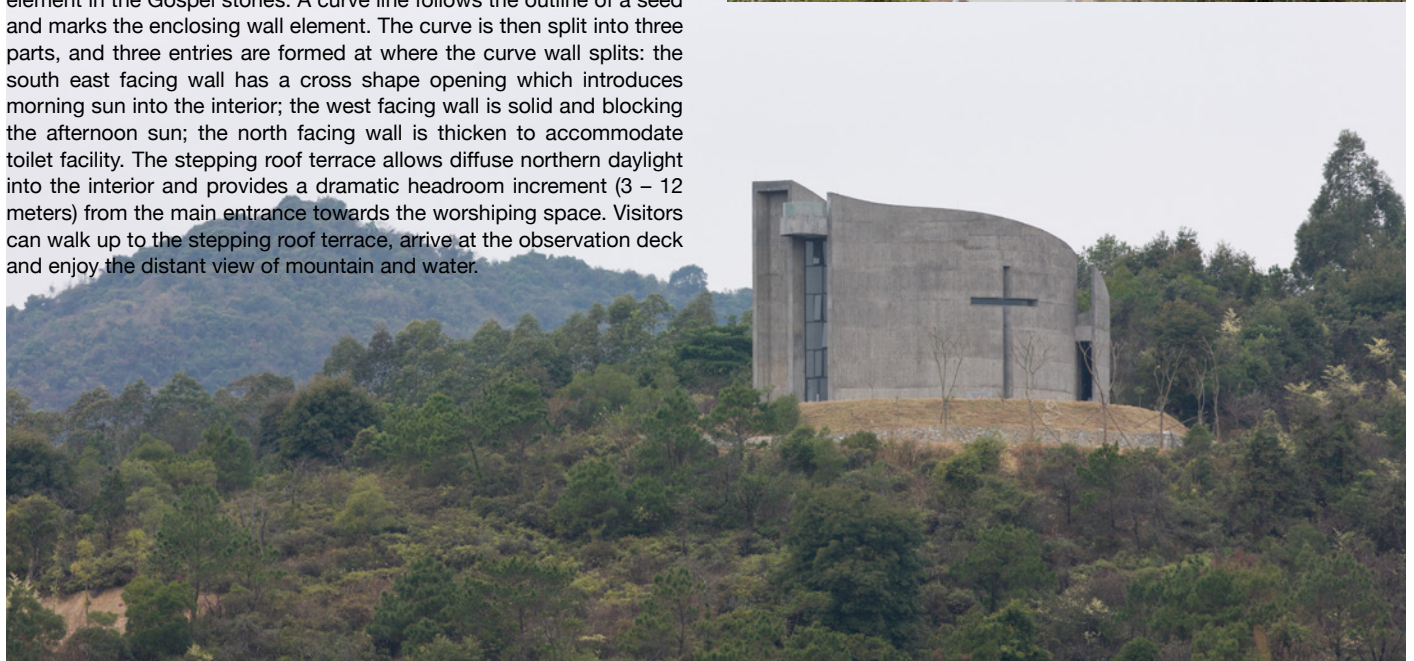

Church of Seed
 Certificate of Excellence, 2012 Perspective Awards
 Medal of the Year, 2011 HKIA Annual Award
 Winner, 2011 World Architecture Community Award

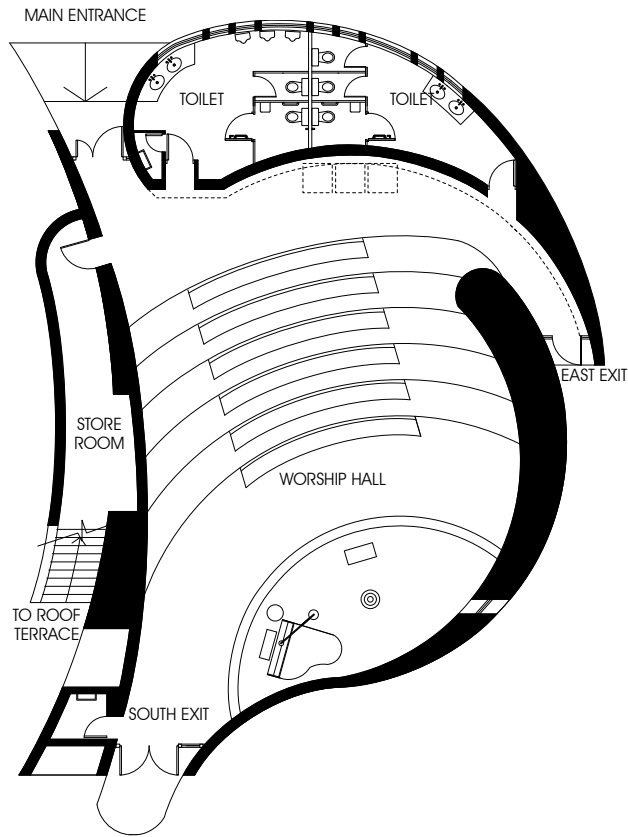

Floor Plan



Worship Hall Interior



Worship Hall Interior

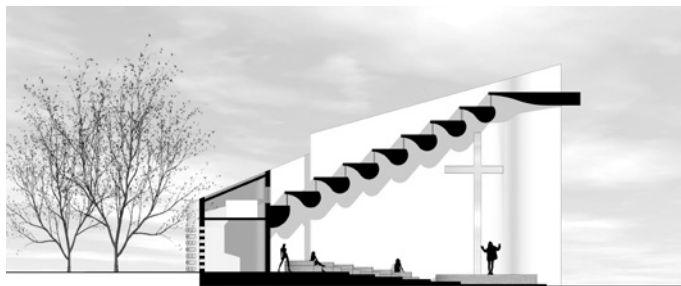

Section



View Towards Distant Mountains

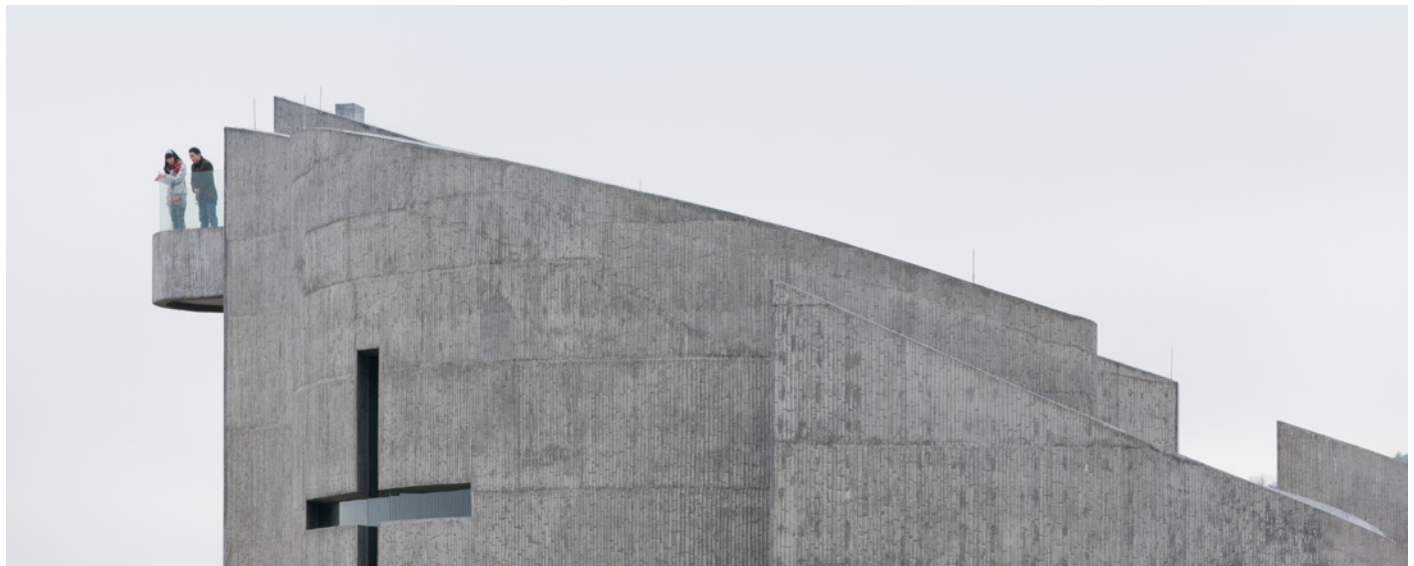

On the Roof

Church of Seed

Certificate of Excellence, 2012 Perspective Awards
Medal of the Year, 2011 HKIA Annual Award
Winner, 2011 World Architecture Community Award



Cross Opening



Playing on the Roof



View towards Distant Mountains



Bamboo Textured Wall



Bamboo Formworks



Concrete Wall Mock-up

Church of Seed has a raw, natural and non-decorative material language. The main structure is constructed by in-situ concrete with bamboo formworks. In-situ concrete construction is economically sound and practical for local builders. The bamboo texture left on the concrete surface reduces the massiveness of concrete wall and harmonizes with the surrounding trees and green landscape. Plus the transparent windows and doors, and the handmade bamboo furniture by local farmers, the presence of the church is humble and close to village life.



Church of Seed serves different age groups of the surrounding villages, for not only religious purpose but also general gathering activities.